

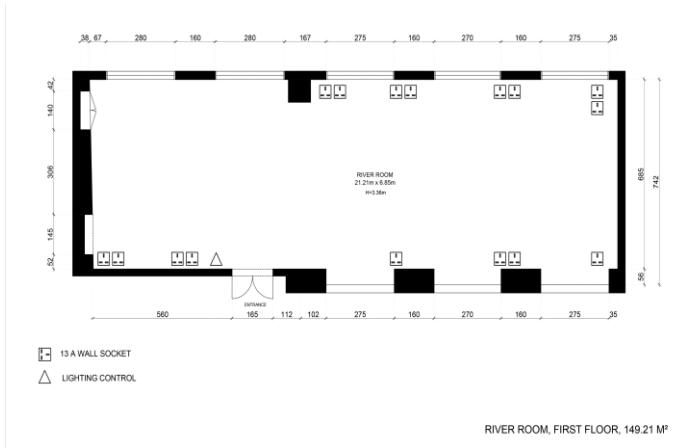

Situated on the River Thames and offering spectacular views of the City, the River Room with its panoramic floor to ceiling glazed arches is the perfect setting to inspire your guests at a gala dinner or reception. The River Room can accommodate up to 180 guests for a networking luncheon or canapé reception and up to 100 guests for a dinner.



AUDIO VISUAL EQUIPMENT

- LED LIGHTING PACKAGE
- 1 PROJECTOR AND PROJECTION WALL
- 1 HANDHELD MICROPHONE
- 1 LECTERN MOUNTED MICROPHONE
- PA SYSTEM
- STAGING
- 100MB FIBRE OPTIC BROADBAND

CAPACITY

THEATRE STYLE	140
CLASSROOM	63
CABARET	100
DINNER	100
DINNER DANCE	80
BOARDROOM	36
STANDING RECEPTION	180