

Directly on the River Thames, the Bridge Room is a multi-purpose space suitable for meetings, small conferences and away days.

With views over the City, the Bridge Room provides river views for up to 60 of your most important dinner guests, with the adjoining Thames Room for a pre-dinner reception.

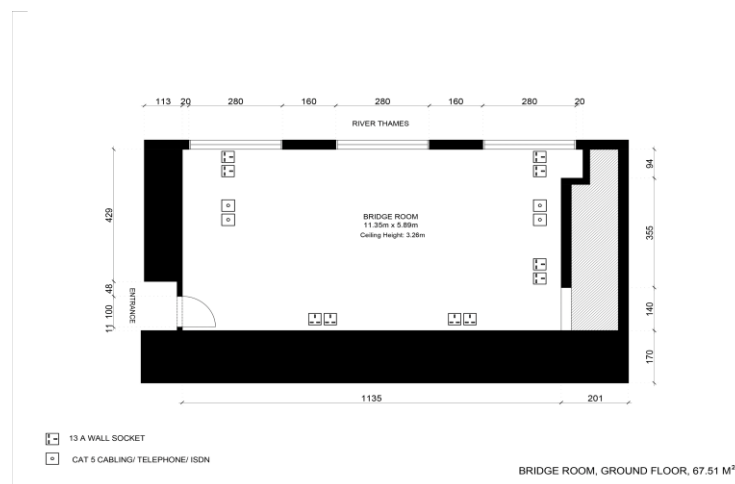

## AUDIO VISUAL EQUIPMENT

PROJECTOR AND SCREENS  
LECTERN AND MICROPHONE  
PA SYSTEM  
STAGING  
100MB FIBRE OPTIC BROADBAND

## CAPACITY

THEATRE STYLE	75
CABARET	48
DINNER	60
BOARDROOM	30
STANDING RECEPTION	70